

USER MANUAL

MobilePilot by Searebbel

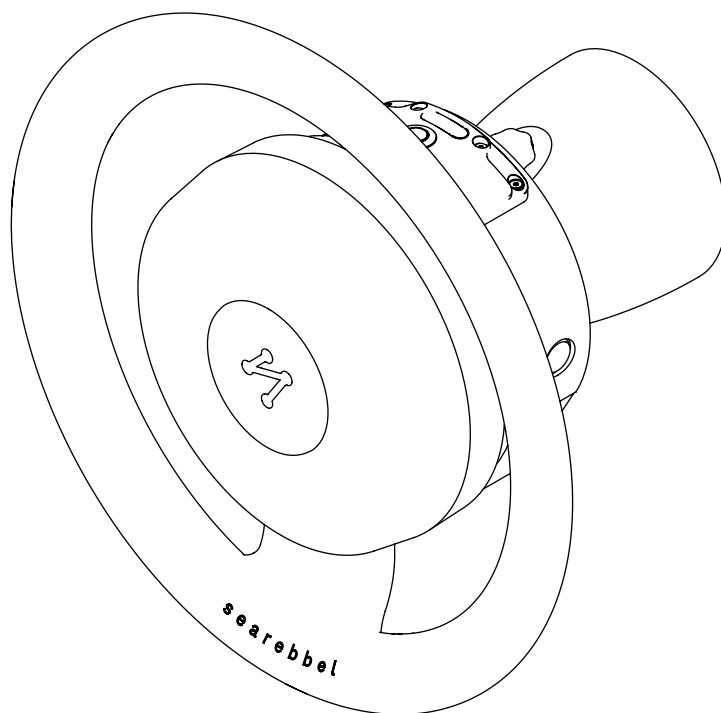

⚠ ATTENTION:

The MobilePilot system does not replace the active, constant, and direct supervision of the person responsible for operating the vessel.



⚠ ATTENTION: MobilePilot is a smart assistant navigation system that under no circumstances replaces the control or the active, constant, and direct supervision of the person responsible for operating the vessel. Ignoring this warning may lead to serious safety risks.

IMPORTANT: PLEASE READ THIS MANUAL CAREFULLY BEFORE INSTALLING OR USING THE MOBILEPILOT.

- The MobilePilot, developed and manufactured by SEAREBBEL S.L., is a smart assistant navigation system that in no case replaces the active supervision of the person in charge of steering the vessel.
- The user or operator of the system must be the person responsible for steering the vessel, duly certified with the license required by applicable law.
- The user must strictly follow the safety rules and warnings indicated in this manual and is responsible for the proper installation, maintenance, and use of the device.
- When activating the MobilePilot, the user must strictly follow all the instructions in this manual. In addition, they must first ensure the vessel is in optimal condition and that the MobilePilot has been correctly installed to avoid deviations or unexpected maneuvers.

BEFORE USING MOBILEPILOT

- Before connecting and installing the wheel, remove all packaging and transport protectors.
- Always install the wheel on a firm surface, ensuring it is properly secured.
- Use the device solely for assisting in boat steering. Do not use it for other purposes, as it may cause damage not covered by the warranty.
- When cleaning, do not submerge the wheel in water or rinse it under running water. Use a soft, damp cloth for cleaning.
- If you detect any damage to the wheel or its electronic components, contact technical support before continuing its use.
- If the system's electrical wiring is damaged, it must be repaired or replaced by the manufacturer, after-sales service, or qualified personnel to avoid navigation risks.
- Always disconnect the power supply before performing any maintenance, adjustments, or installation tasks.
- This device must only be operated by individuals knowledgeable in maritime navigation and safety, who possess the necessary certification or license as required by law.





USAGE LIMITATIONS

The MobilePilot system MUST NOT be used under any circumstances:

- As a substitute for the manual, active, and constant control of the vessel by the person in charge.
- On vessels used for commercial or professional purposes without prior written authorization from SEAREBBEL S.L.
- Under adverse weather conditions, poor visibility, or any situation that may compromise navigation safety.
- If any looseness, anomaly, strange noise, or irregular response is detected after installation or during use. In such cases, immediately disconnect the device and contact your dealer or authorized distributor.
- In situations with risk of direct or prolonged exposure to factors that could damage electronic components. Always ensure all electrical connections are properly protected from moisture and corrosion.
- If the device shows faults, visible damage to cables or connections, or has suffered any impact or drop that could have affected its integrity or functionality.

NORMAS DE SEGURIDAD

1. Install the MobilePilot system strictly following the manufacturer's (SEAREBBEL) instructions.
2. The device should only be used after a successful installation and configuration according to the manual.
3. Regularly check the system's condition. Technical checks of the MobilePilot are recommended every 6 months. These checks should also be done after long periods of disuse (more than three months), after adverse weather conditions, or immediately after any incident or impact that may have affected the device's integrity or function.
4. Use the MobilePilot only in weather conditions suitable for safe navigation.
5. Always maintain the ability to manually take control of the vessel.
6. In case of malfunction, anomaly, or loss of control of the MobilePilot system, immediately switch to manual control as indicated in the relevant manual section.
7. In accordance with applicable maritime safety regulations, the installation of the MobilePilot system may be considered a significant modification to the vessel's steering system, which could require additional approval by the Maritime Authority. It is your responsibility to be informed and to comply with the administrative and technical requirements established by the competent authority.
8. This modification should also be reported to your vessel insurance provider before installation to verify it is covered by your policy. Failure to comply may result in partial or total exclusion of mandatory insurance coverage.



TABLE OF CONTENTS

1. Specifications	pag.9
2. MobilePilot Description	pag.10
3. Packaging	pag.12
3.1.Included Items	pag.14
3.2.Non-Included Items	pag.16
4. MobilePilot Installation	pag.18
4.1. Step 1: Removal of the Passive Steering Whee	pag.18
4.2. Step 2: Mounting Plate Installation	pag.20
4.2.1. Types of Installation	pag.20
a) Installation with 3 screws	pag.22
b) Installation with 4 screws	pag.23
c) Installation with adhesive Velcro	pag.24
d) Non-standard installation	
4.3. Step 3: Shaft Adapter Installation	pag.25
4.3.1. Types of Installation	pag.25
a) Male Shaft	pag.26
b) Female Shaft	pag.27
4.4. Step 4: Mounting the MobilePilot	pag.28
4.5. Step 5: Centering to Straight Course	pag.30
5. App Pairing	pag.32
6. Activating the MobilePilot Without the App	pag.36
6.1. Visual and Auditory Alerts	pag.38
7. Warranty	pag.40
8. Legal Notice and Disclaimer	pag.42
9. Glossary of Terms	pag.45
9. Annex	pag.46



1. SPECIFICATIONS

MODEL: MOBILEPILOT AUR

VOLTAGE: 12VDC / 24VDC - 3A

WEIGHT: 9.95KG

DIMENSIONS: 350 X 132 mm

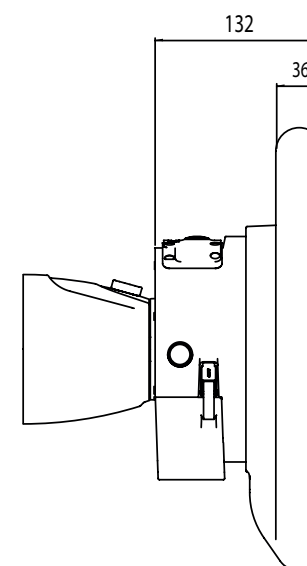
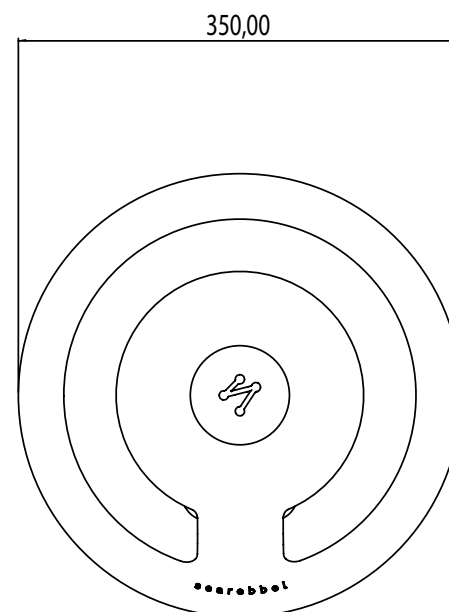



2. MOBILEPILOT DESCRIPTION

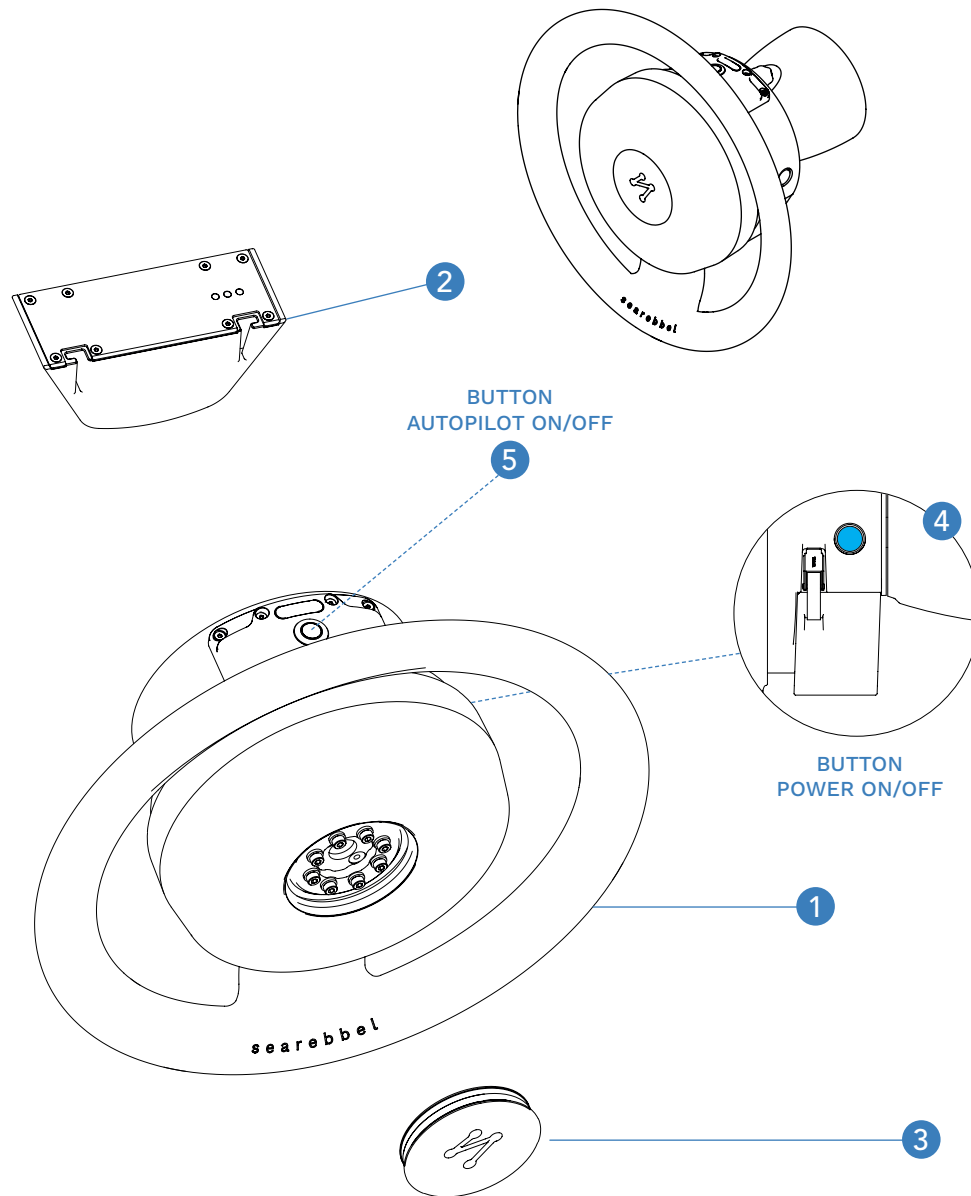

- 1 MOBILEPILOT
- 2 BATTERY
- 3 COVER
- 4 BUTTON POWER ON/OFF
- 5 BUTTON AUTOPILOT ON/OFF

The Searebbel MobilePilot is a smart assistant navigation system that transforms a vessel's traditional helm into a motorized wheel that can be controlled via mobile devices. This innovative product is designed to simplify navigation and enhance onboard safety.

- Motorized wheel: Replaces the vessel's passive steering wheel with an active steering wheel that performs as an autopilot.
- Mobile control: Using the Searebbel app, available for mobile devices, the vessel can be controlled via Bluetooth connection.
- Simple installation: The system is designed to be installed in under 15 minutes without any modification to the vessel, thanks to its "Plug & Play" approach.
- It features an integrated rechargeable battery, making it 100% autonomous.

Thank you for choosing Searebbel's MobilePilot!

Our entire team wishes you an extraordinary navigation experience.

Upon receiving the product, please ensure that the packaging shows no damage that could have affected the device inside.

Once the product has been unpacked, we recommend keeping the packaging for a reasonable period until you have confirmed that the wheel is functioning properly.

IMPORTANT: Separate the packaging materials according to their composition and dispose of them in the appropriate recycling containers. Regularly check the condition of the system/mounting (MECHANICAL PART). These checks should also be carried out after prolonged periods of disuse (more than three months), following adverse weather conditions, or immediately after any incident or impact that may have affected the integrity or functionality of the device.



3. PACKAGING

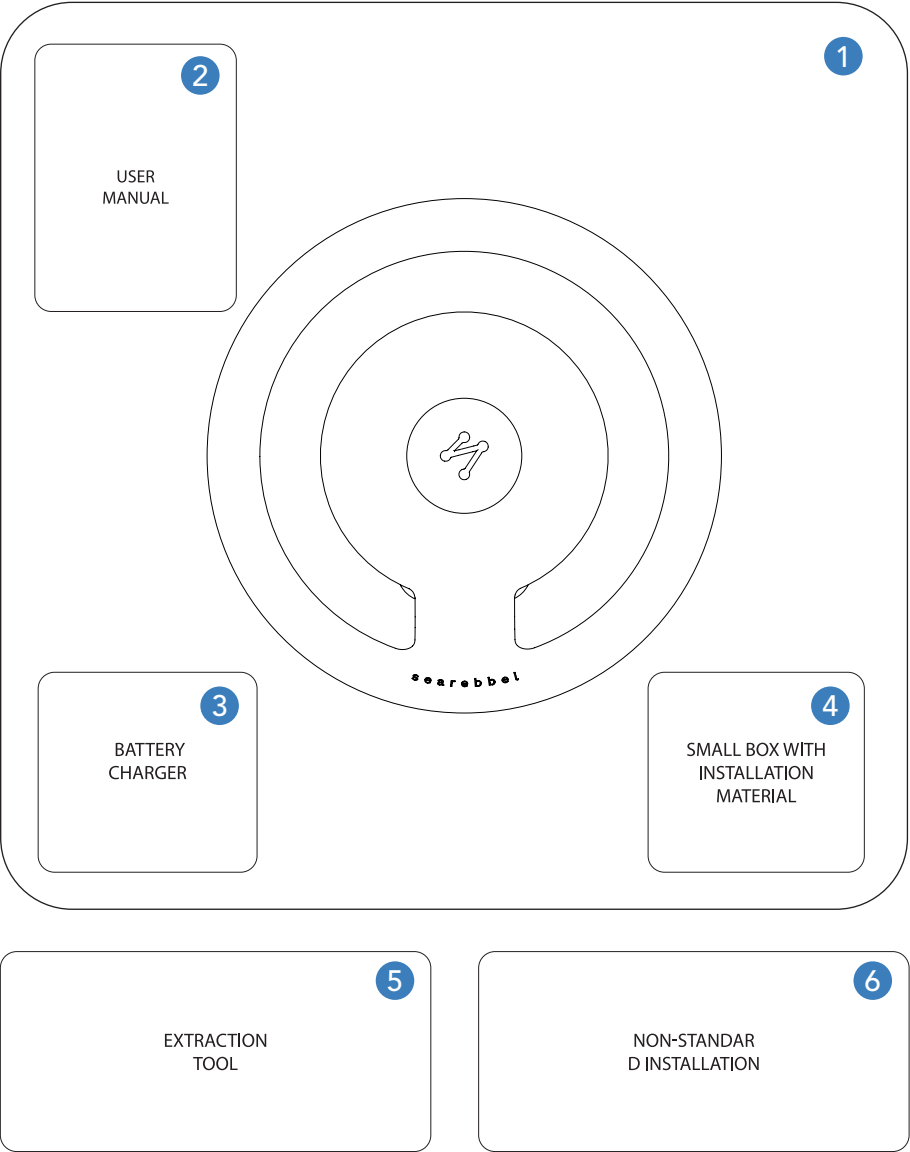

The MobilePilot packaging is designed to protect and organize all components required for installation. Inside, you will find the main body of the device, standard fastening elements (screws or Velcro, depending on the model), and the basic accessories for initial assembly.

All included items are arranged in an orderly manner.

⚠ Non-included items

Some specific components are not included in the basic MobilePilot package and must be purchased separately if required for your type of installation.

INCLUDED IN THE MOBILEPILOT PACKAGING

- 1 BOX + MOBILEPILOT
- 2 USER MANUAL
- 3 BATTERY CHARGER
- 4 INSTALLATION COMPONENTS

NOT INCLUDED IN THE MOBILEPILOT PACKAGING

- 5 EXTRACTION TOOL
- 6 NON-STANDARD INSTALLATION COMPONENTS



3.1 INCLUDED ITEMS

(Figure 1)

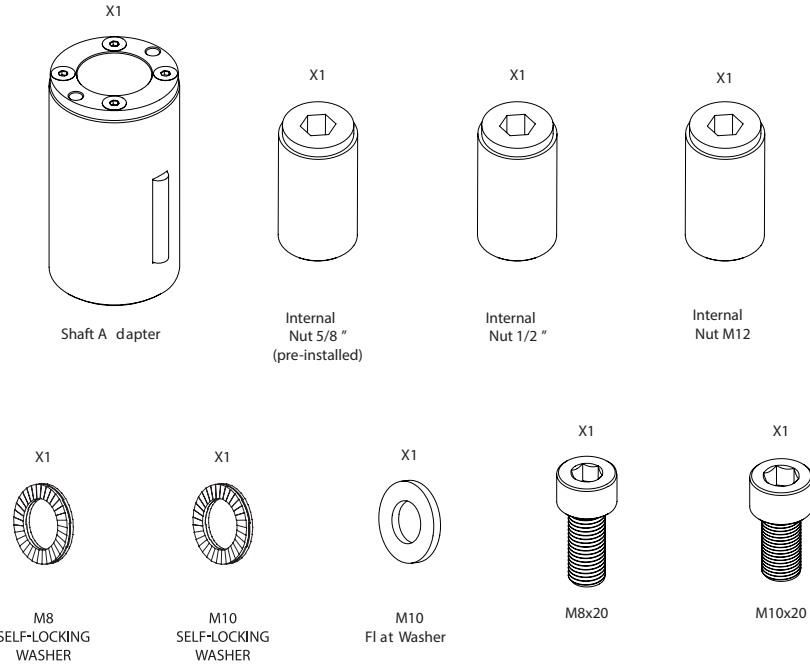

(Figure 2)

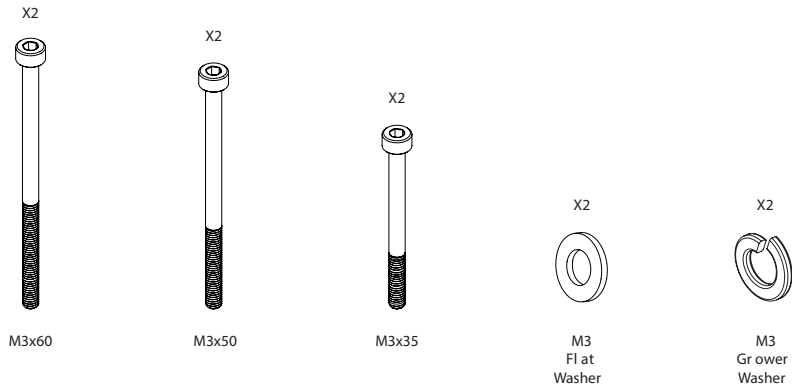

(Figure 3)

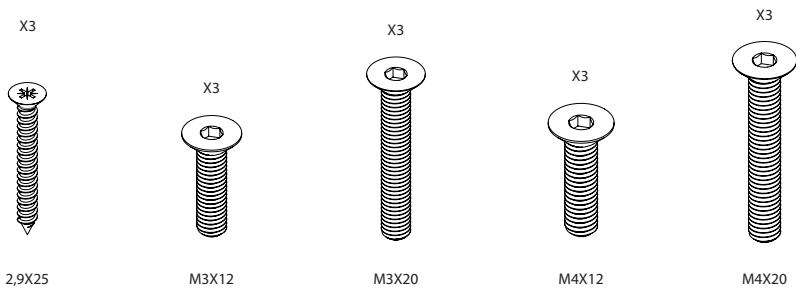

(Figure 4)

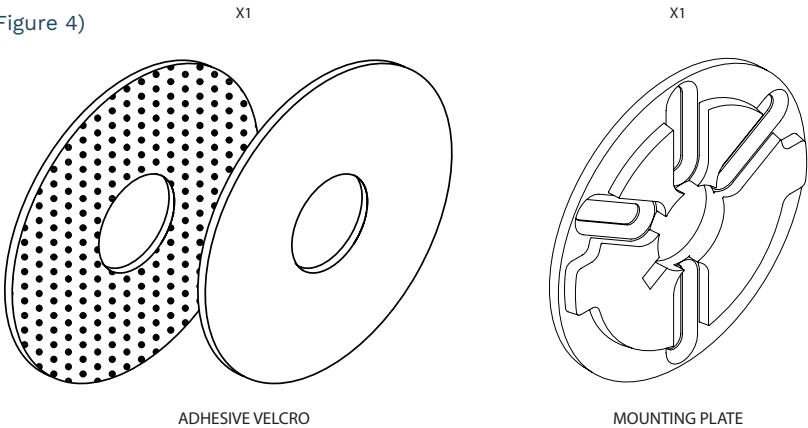

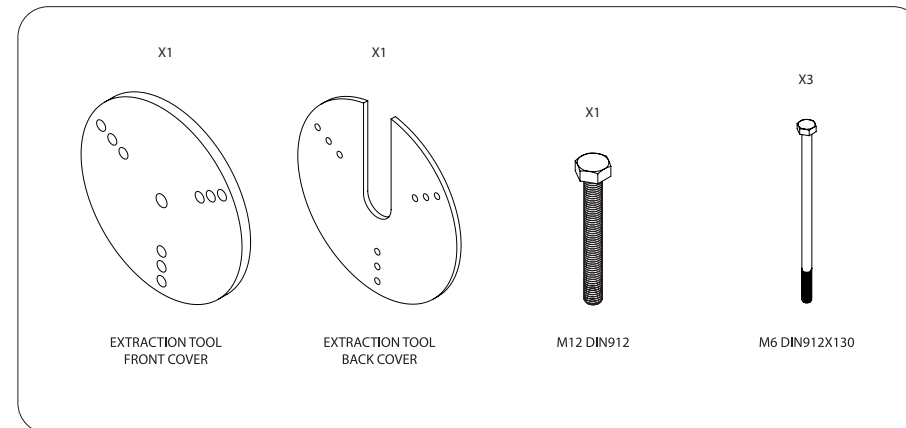
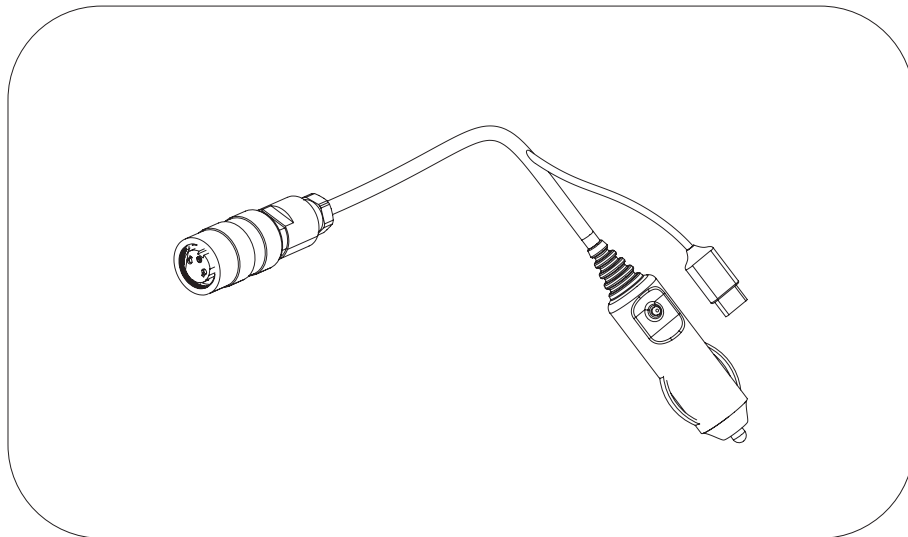

* Extraction tool

3. PACKAGING

3.2. NON-INCLUDED ITEMS

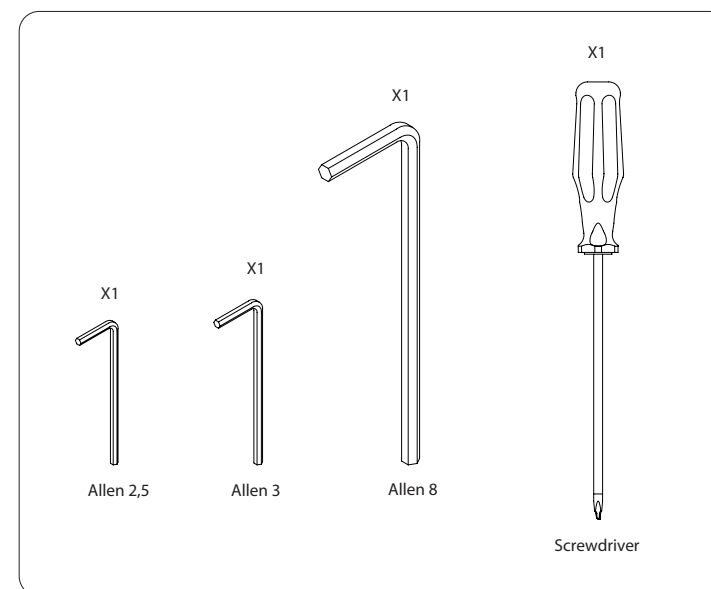
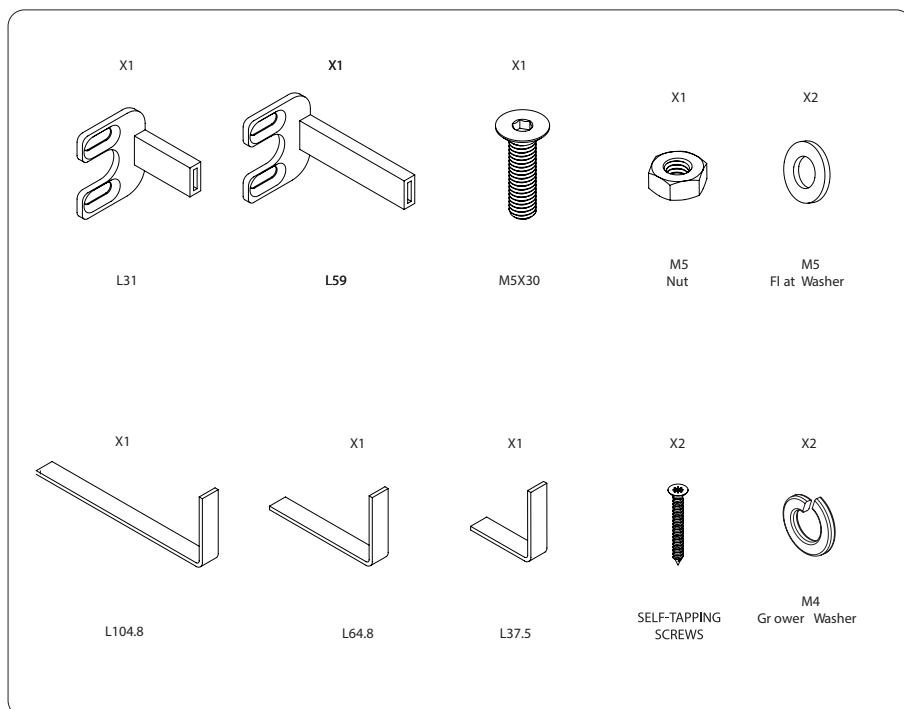

* Tools required for installation

IMPORTANT: Regularly check the condition of the system/mounting (MECHANICAL PART). These checks should also be carried out after prolonged periods of disuse (more than three months), following adverse weather conditions, or immediately after any incident or impact that may have affected the integrity or functionality of the device.



4. MOBILEPILOT INSTALLATION

4.1.STEP 1: REMOVAL OF THE PASSIVE STEERING WHEEL

Below is a description of how to remove the wheel based on a standard nautical steering configuration. Please note that this configuration may vary depending on the type of boat and its steering system.

1

1. Removing the steering wheel cover

- Remove the cover of the conventional steering wheel by pulling it firmly.
- It is usually press-fitted. If it resists, use a plastic lever to avoid damage.

2

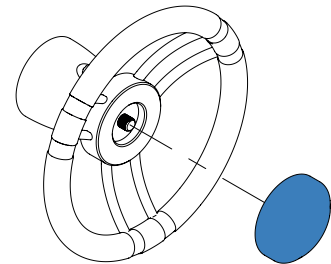

3

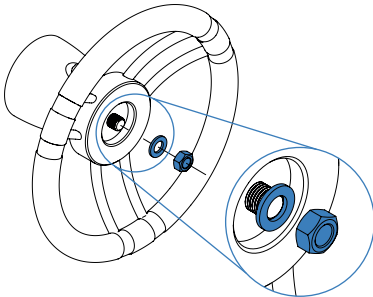

2.Removing the steering wheel nut

- Unscrew the nut that secures the steering wheel to the shaft using an appropriate wrench, turning counterclockwise.
- Once removed, store it in a safe place.

3

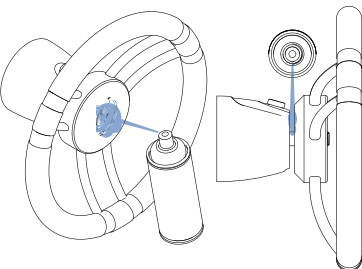

3. Penetrating Oil Application

- Apply penetrating oil to the contact areas between the steering wheel and the shaft.
- Make sure it is well lubricated and let the oil sit for at least 5 minutes before attempting to remove the wheel. It is advisable to apply the penetrating oil the day before removal.

Sometimes, the steering wheel can be loosened by applying sharp, controlled taps from the rear and around its perimeter. If this method does not work, it is possible that the wheel has become stuck to the shaft due to salt buildup. In such cases, it is recommended to use a shaft puller.

Below is the procedure using the extraction tool designed by Searebbel.*

* Extraction tool sold separately.

4

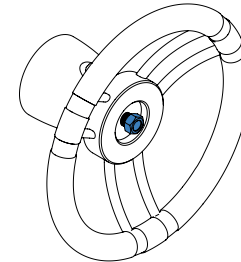

4. Preparation for using the extraction tool

- Lightly screw the nut removed in step 2 back onto the shaft so it can serve as a guide for the extraction bolt.

5

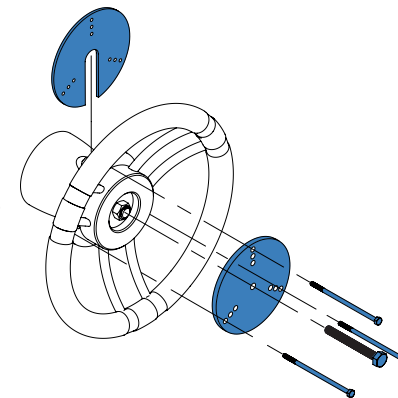

5. Extraction Tool Setup

- Fit the rear plate to the back of the steering wheel, as shown in the diagram.
- Place the front plate on the front side, aligning it with the rear plate.
- Insert the perimeter screws (M6 – Extraction Tool) into the aligned holes, using the hole closest to the center that your wheel allows. Screw them in until flush, ensuring both plates are parallel.
- Thread the central screw (M12) until it makes contact with the shaft, using the nut from the previous step as a guide.
- Gradually tighten the central screw to apply pressure on the wheel and ease its removal.
- If the wheel does not release, apply a sharp, firm tap to the central screw and repeat from step 5.

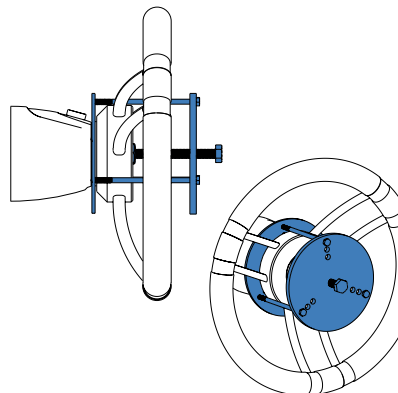

- Once the wheel is loose, first remove the central screw, then the perimeter screws, holding the rear plate to prevent it from falling. Remember to unscrew the central nut before completely removing the steering wheel.



4.2. STEP 2: MOUNTING PLATE INSTALLATION

4.2.1. Types of Installation

a Installation with 3 screws pag. 22

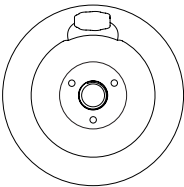

- If your steering system has an external hydraulic pump with 3 screws, as shown in the diagram, use this installation method

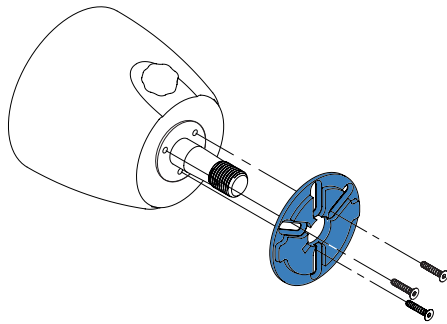
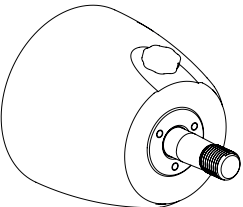

c Installation with adhesive Velcro pag. 24

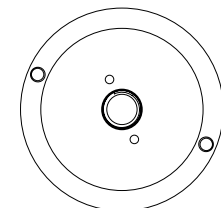

- If your steering system has an external hydraulic pump without radial screws, or a cover — both with a flat surface — as shown in the diagram, use this installation method.

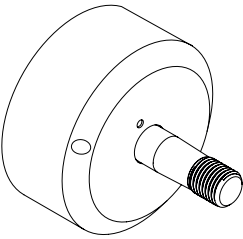

b Installation with 4 screws pag. 23

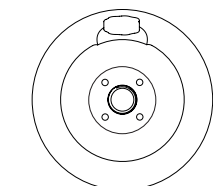

- If your steering system features an external hydraulic pump with 4 screws, as shown in the diagram, use this installation method.

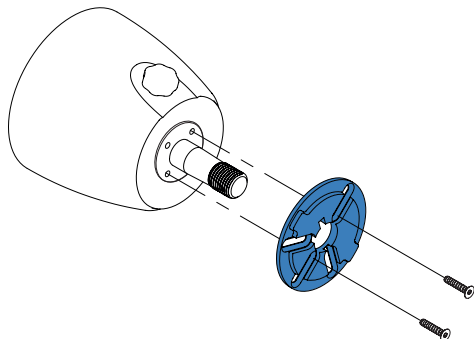
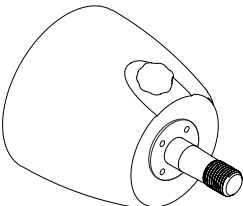

d Non-standard installation

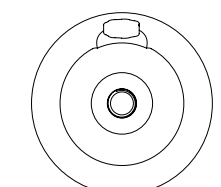

- If your steering system does not match any of the above cases, please contact your official distributor.

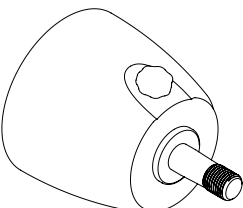

a) Installation with 3 screws

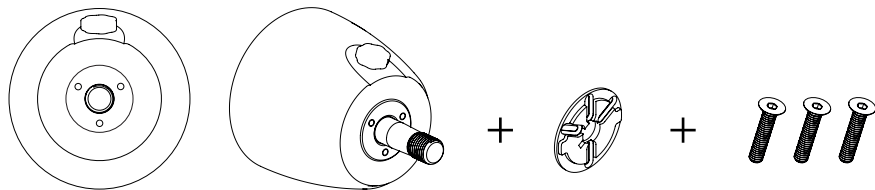

*Materials required for installation

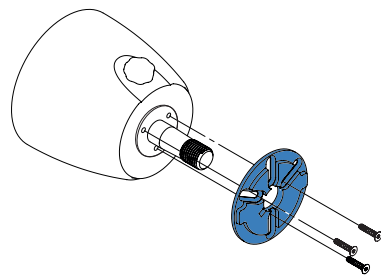

1. Remove the 3 front screws from the hydraulic pump and set them aside.

2. Insert the mounting plate so that the slots positioned at 120° align with the screw holes.

3. Reinsert the three screws into their respective positions*.

4. Tighten the screws evenly and progressively to ensure the proper centering of the mounting plate.

* If the thickness of the mounting plate prevents proper insertion of the original screws, use the screws included in the packaging (Figure 3, p.17).

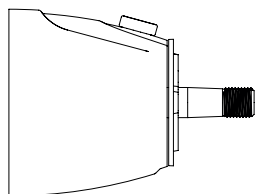
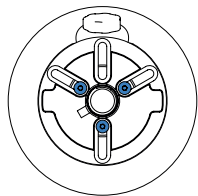

Recommendations

Make sure the plate is properly seated before tightening the screws.

Use the appropriate tool to avoid damaging the threads.

Do not force the screws; tighten them progressively in a criss-cross pattern for even distribution.

b) Installation with 4 screws

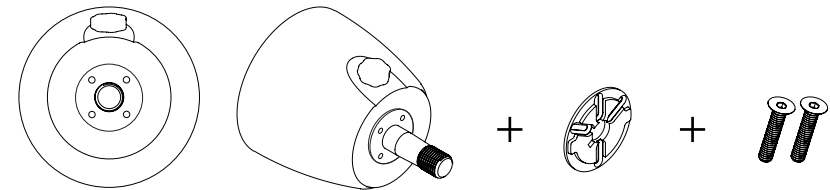

*Materials required for installation

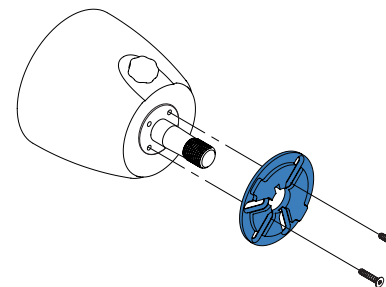

1. Remove 2 of the 4 front screws from the hydraulic pump and set them aside.

2. Insert the mounting plate so that the slots positioned at 180° align with the position of the open holes.

3. Reinsert the 2 screws into their respective positions*.

4. Tighten the screws evenly and progressively, ensuring the proper centering of the mounting plate in relation to the shaft.

* If the thickness of the mounting plate prevents proper insertion of the original screws, use the screws included (Figure 3, p.17).

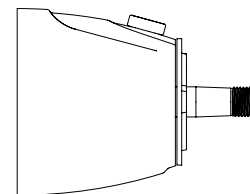
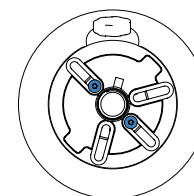

Recommendations

Make sure the plate is properly seated before tightening the screws.

Use the appropriate tool to avoid damaging the threads.

Do not force the screws; tighten them progressively in a criss-cross pattern for even distribution.



c) Installation with adhesive velcro

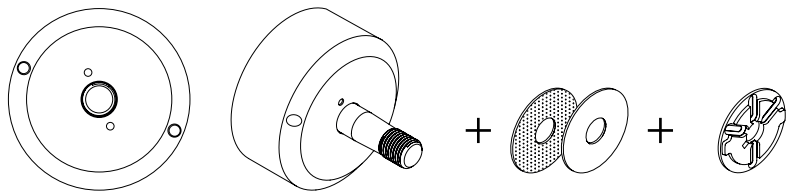

*Materials required for installation.

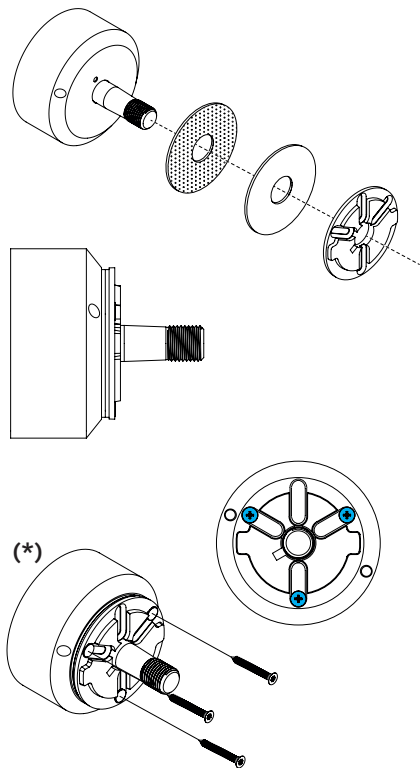

1. Clean the surface at the base of the shaft with alcohol or a similar product. Make sure it is clean and dry before applying the adhesive Velcro.

2. Stick one side of the Velcro, keeping it aligned with the shaft.

3. Stick the other side of the Velcro to the back of the mounting plate, ensuring that the central holes are aligned.

4. Insert the mounting plate, centering it with the shaft and securing it with the Velcro so that the notches on the plate are in a horizontal position, as shown in the diagram.

OPTIONAL: If the installation is done over a hollow cover, it can be reinforced with self-tapping screws (). Perform this step only after the full installation is completed and it has been verified that the wheel is perfectly aligned.

Recommendations

Apply even pressure to the adhesive to improve bonding and prevent premature detachment.

WARNING: Do not attempt to secure the mounting plate with screws if your steering system includes an external hydraulic pump, as this could cause damage.

4.3. STEP3: SHAFT ADAPTER INSTALLATION

4.3.1. Types of Installation

a Male Shaft pag. 30

If your vessel has a male-threaded shaft, follow this type of installation.

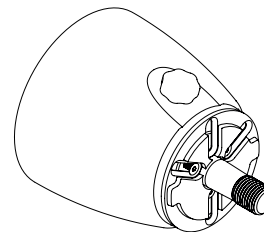

b Female Shaft pag. 31

If your vessel has a female-threaded shaft, follow this type of installation.

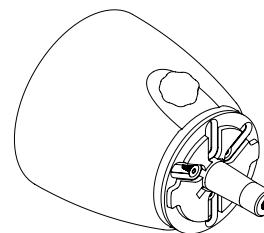



a) Male Shaft

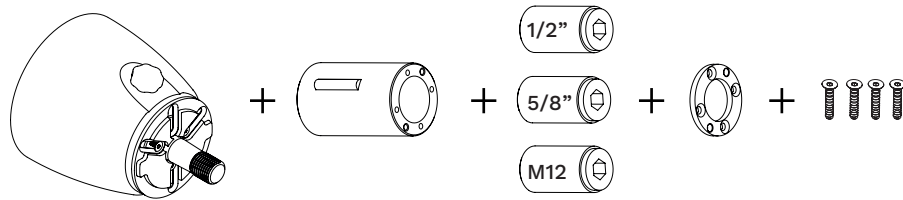

Clean and grease the shaft before starting the process.

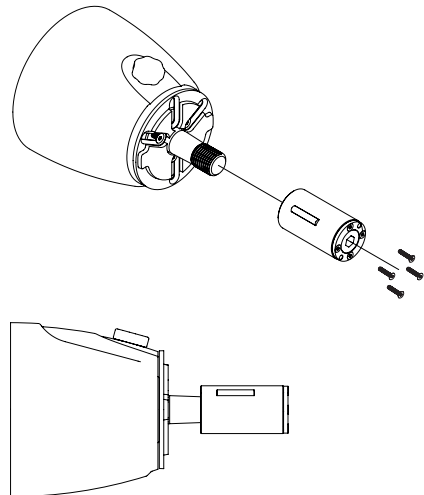

1. Check the thread size of your shaft.
2. If the pre-installed nut does not fit your shaft, follow these steps:
 - a) Remove the cover of the shaft adapter (attached with 4 screws).
 - b) Replace the internal thread with the one that fits your shaft (M12, 1/2", or 5/8").
 - c) Reinstall the adapter cover.
- 3) Install the adapter onto the shaft using an 8 mm Allen key, tightening the thread firmly onto the shaft.

Recommendations

Use appropriate tools to avoid damaging the thread or the screws.

Tighten the screws evenly to ensure a secure fit.

b) Female Shaft

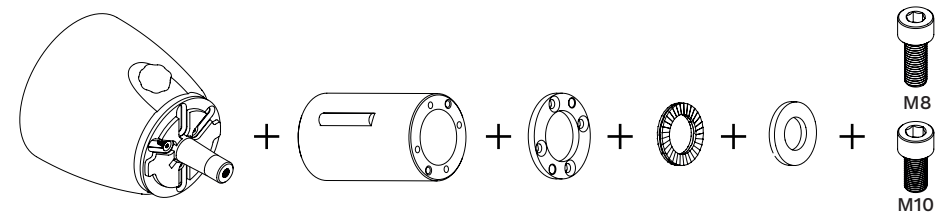

Clean and grease the shaft before starting the process.

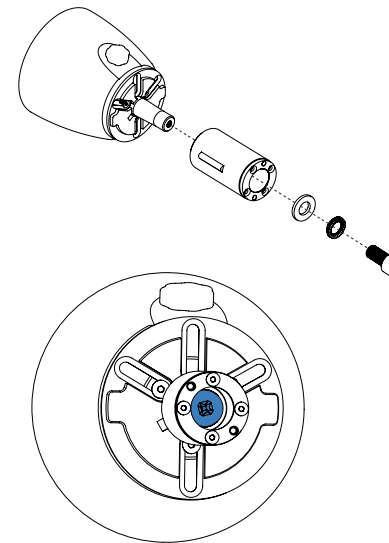

Clean and grease the shaft before starting the process.

1. Remove the pre-installed nut from the shaft adapter by taking off the adapter cover (attached with 4 screws).
2. Check the thread size of your shaft and select the appropriate screw (M8 or M10).
3. Install the adapter onto the shaft using the corresponding Allen key. Make sure to install the washers in the order shown at the top of the page and tighten the screw firmly

Recommendations

Use appropriate tools to avoid damaging the screw thread.

Tighten the screw gradually to ensure a stable fit without over-tightening.

Check the alignment before securing the assembly to avoid misalignment during installation.



4.4. STEP 4: MOUNTING THE MOBILEPILOT

1. Align the steering wheel with the shaft and carefully fit it in place. Make sure the key is correctly positioned to allow insertion of the MobilePilot.
2. Position the back of the MobilePilot with the activation button (Fig. 1) facing upward, and ensure it fits properly with the mounting plate installed in Step 2.
3. Once the wheel is fitted, secure it using the two M3 screws that best match your steering system. Make sure to install the washers in the correct order as shown in Figure 2.
4. Tighten the screws evenly to avoid any play.

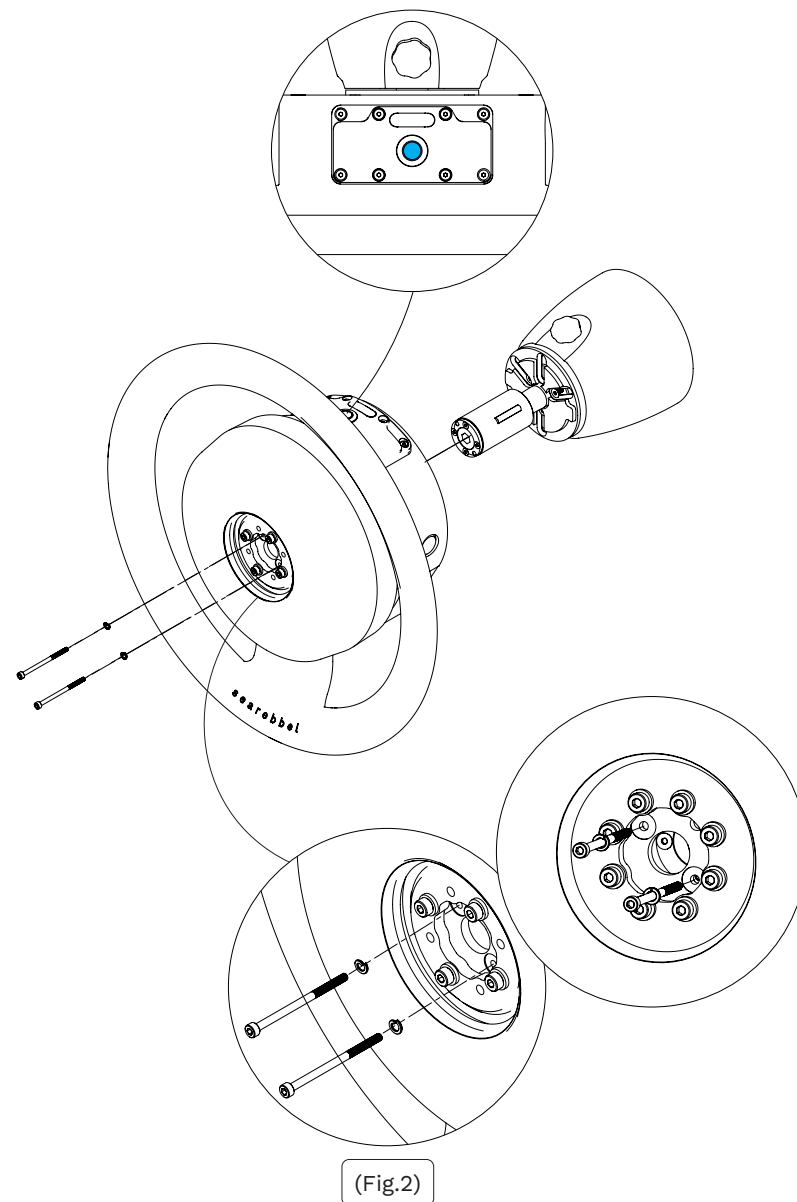
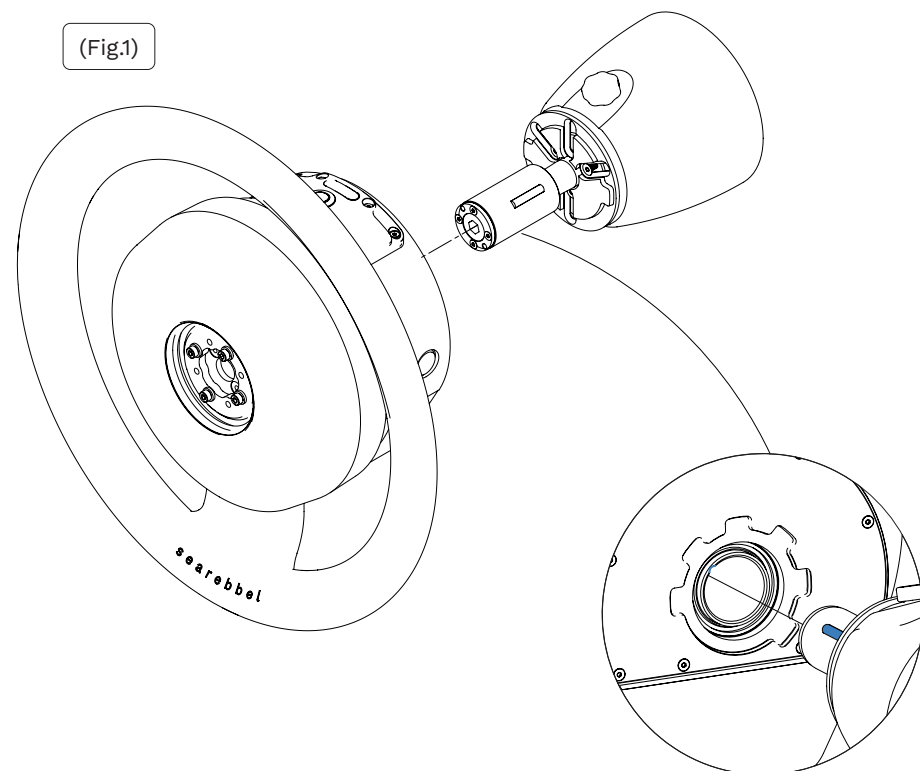

Recommendations

Check the alignment of the steering wheel before tightening the screws.

Do not force the fit—if the wheel does not slide in easily, check the position of the key.



4.5. STEP 5: CENTERING TO STRAIGHT COURSE

1. Center the rudder (rudder or outboard motor aligned to the straight position).
2. If the MobilePilot steering wheel is not in its lowest spoke position when the rudder is centered, remove the 4 screws securing it and reposition it accordingly.
3. Make sure the screws are firmly tightened.
4. Place the steering wheel cover in position over the center of the wheel.

Recommendations

- Do not apply excessive force; the cover should fit with even pressure.
- Ensure the surface is clean before installing the cover to prevent it from loosening over time.
- Perform a steering wheel rotation test to confirm proper installation and ensure there are no obstructions.

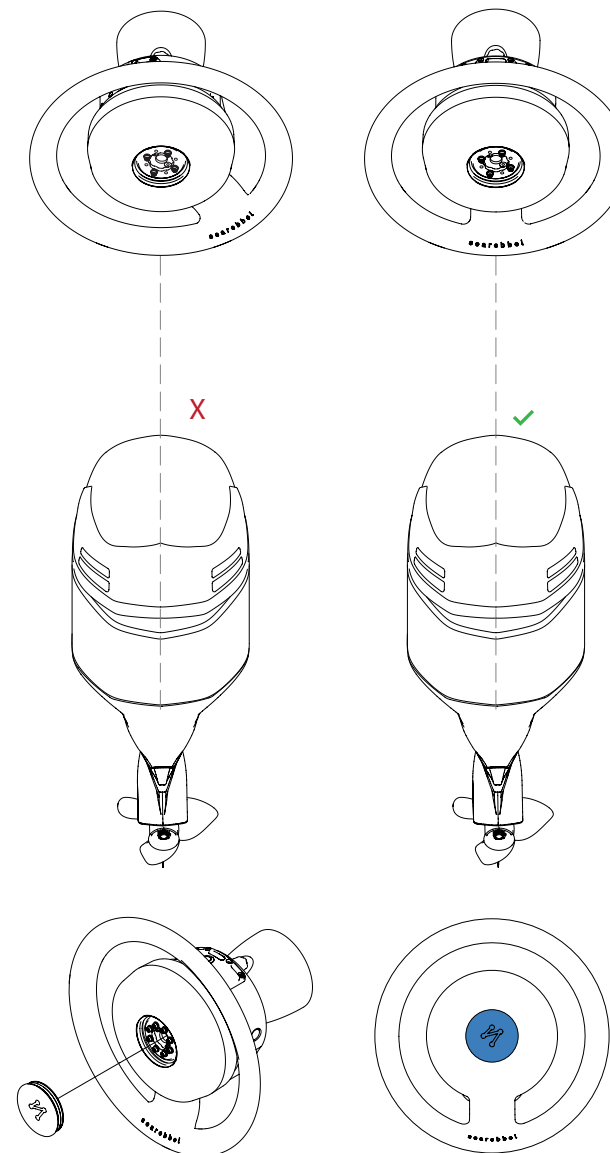

Once the installation is complete, verify that all parts are properly secured and that the steering wheel turns without obstruction. Test the system before using it for navigation, and make sure the autopilot response is correct.

For any questions or issues, contact authorized technical support.



5. APP PAIRING

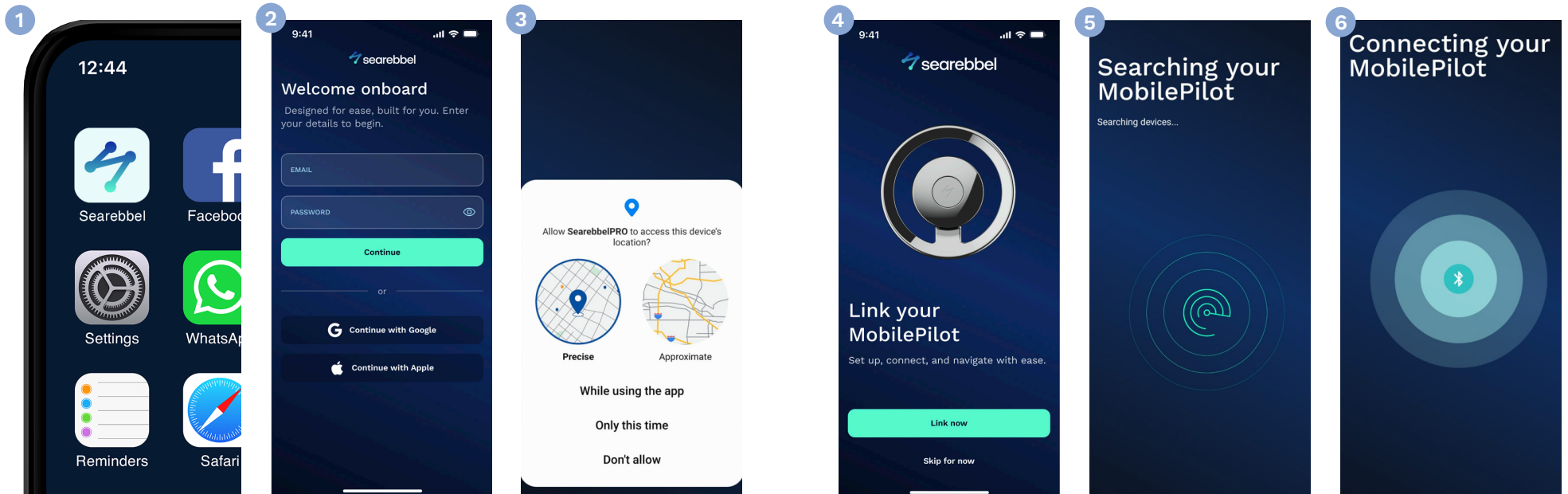

Download and installation of Searebbel App

- Before getting started, make sure the Searebbel app is installed on your mobile device. (1)
- Download the app from the App Store (iOS) or Google Play (Android)
- Open the app and create your account by signing in with Google, Apple, or using an email and password. (2)
- During the registration process, you will need to accept the following legal documents and terms of use: Privacy Policy, Legal Notice and Safety Guidelines, Terms of Use, and Warranty & Responsibilities.
- Read the terms carefully and tap “Accept” to continue.
- During the process, location permissions must be granted for the app to function correctly. (3)

Bluetooth Activation and Pairing with the MobilePilot.

Tap the “Link now” button to start searching for devices. Wait for the app to detect the steering wheel in the list of available devices. Next, select the MobilePilot you want to connect to in order to complete the pairing. (4, 5, 6)

If the pairing is successful, a confirmation signal will appear on the screen. (7)

If the steering wheel does not pair correctly, an error signal will appear. (8)

In that case, follow these steps to resolve the issue:

- Turn the wheel off and back on.
- Disable and re-enable Bluetooth on your mobile device.
- Make sure the wheel has sufficient battery.
- Restart the app and try again.

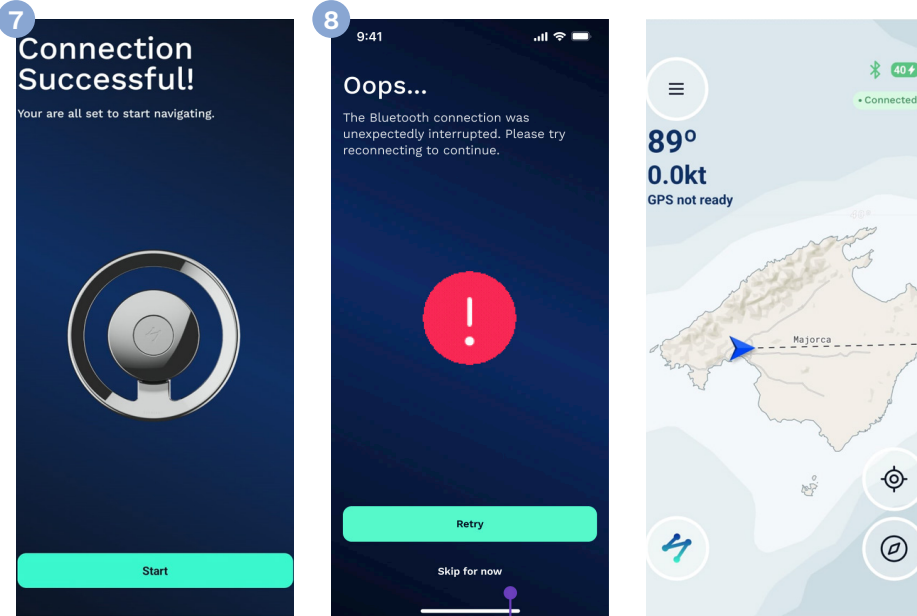

Recommendations

- Make sure the MobilePilot is turned on (ON).
- Manually activate Bluetooth in your device settings.
- Allow location and Bluetooth access in the app settings.
- Check if there are any updates available for the app.
- Draw the route precisely to avoid constant corrections.
- Use “Stop” in case of emergency or if manual adjustments are needed.
- Keep in mind that sudden changes in navigation speed can affect route safety. Always stay alert and deactivate the autopilot in case of any unexpected situation to quickly regain manual control.

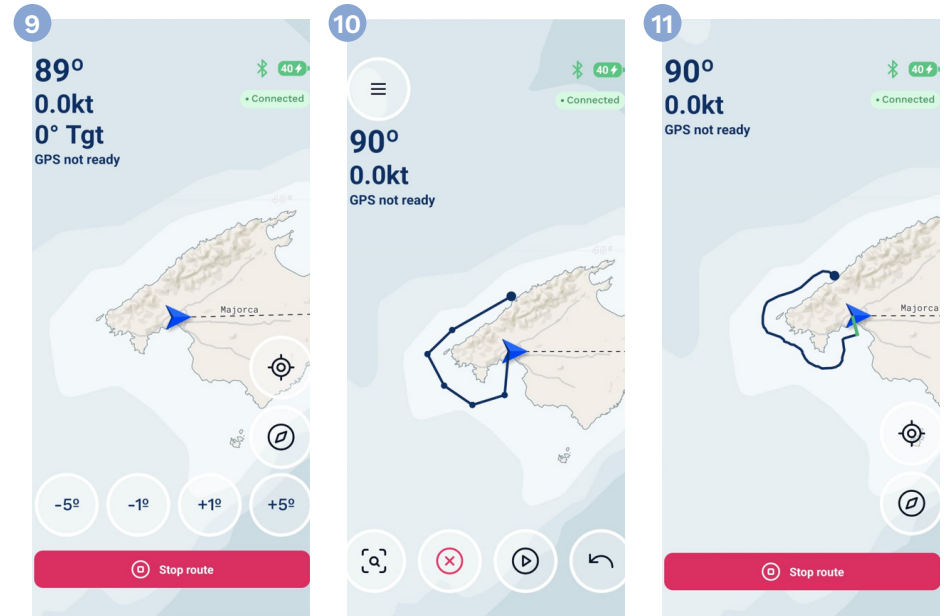

NAVIGATION MODES

Heading / Keep course (9)

- Tap the “Start” button to begin planning your route.
- Tap the “Play” button for the boat to start navigating autonomously, maintaining its heading.
- During navigation, the heading can be adjusted by tapping the Searebbel icon:
 - +5° / -5° → Adjusts the heading.
 - +1° / -1° → Adjusts the heading.
- Tap the “Stop” button to interrupt the autopilot at any time.

Waypoints (10)

- Tap the “Start” button to begin planning your route.
- Define the waypoints on the map. Once the route is set, press Play.
- Tap the “Stop” button to interrupt the autopilot at any time.

Draw Your Route (11)

- Tap the “Start” button to begin planning your route.
- Draw the desired route on the map. Once the route is set, press Play.
- Tap the “Stop” button to interrupt the autopilot at any time.



6. ACTIVATING THE MOBILEPILOT WITHOUT THE APP

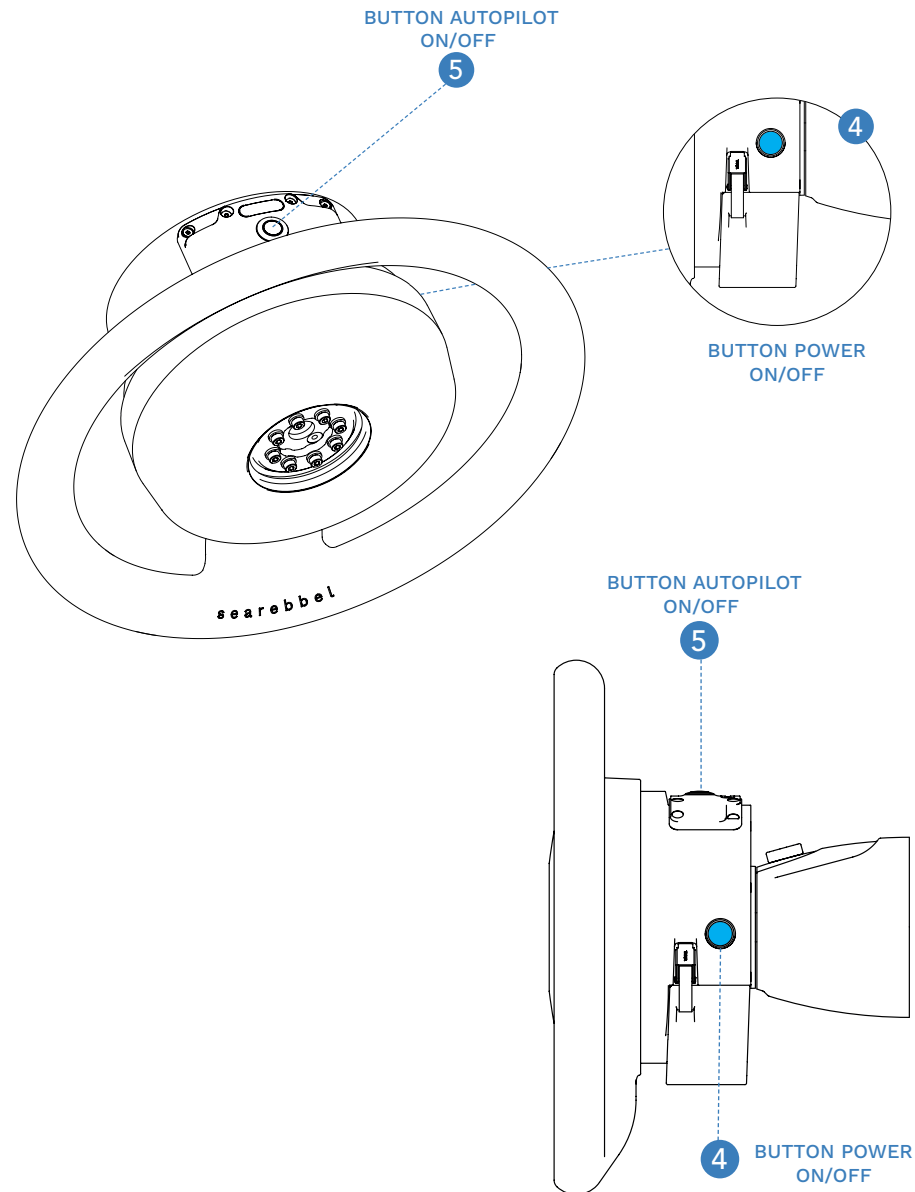

When using the MobilePilot without the app or a connected screen, only the heading hold navigation mode is available. Below is the correct procedure:

1. Power on the MobilePilot
Press the power button (ON).
2. Wait for the startup sequence
The LED will change from red to flashing blue during the configuration process.
3. Ensure minimum speed
For proper setup, the vessel must exceed 3 knots. This ensures that the GPS can accurately acquire position data.
4. System ready confirmation
Once the system is ready, the LED will turn solid blue.
5. Activate navigation mode
When the LED is solid blue, press the MobilePilot activation button. The LED will change to green, indicating that navigation mode is active. The LED will remain green throughout the entire route.
6. Deactivate navigation mode / return to manual control
If you want to deactivate MobilePilot and regain manual control, press the activation button again. The LED will return to solid blue, indicating that the system is in standby and ready to be activated again.
7. Error indicator
If an error occurs, the LED will turn red.

Below is a table detailing the audiovisual signals of the MobilePilot corresponding to each status.



6.1. VISUAL AND AUDITORY ALERTS

Power	Autopilot	Status	LED	Buzzer
off	off	n.a	n.a	n.a
on	off	Not ready	Pulsating blue	n.a
on	off	Ready	Fixed blue	n.a
on	off	Error	Fixed Red	n.a
on	on	Active	Fixed Green	n.a

Notes
<p>When powered on (ON), wait for the system to move to the next phase, indicated by a solid blue light. During this period, the system is establishing a connection with the internal GPS and preparing to operate.</p> <ul style="list-style-type: none">For the internal GPS to activate correctly, the vessel must reach a speed of over 3 knots.The activation process may take up to 10 minutes.If after this time the system does not progress to the next phase, it is recommended to restart the MobilePilot (turning the device off and on again). <p>Important: Do not interrupt the startup process before it is completed, as this could affect the proper functioning of the system.</p>
<p>MobilePilot is ready to be activated.</p>
<p>If an error occurs, we recommend checking the following:</p> <p>Ensure Bluetooth is enabled and properly connected.</p> <ul style="list-style-type: none">Make sure you've accepted location permissions in the app.In some cases, errors may occur if the speed was increased after planning the route, and the system detects that it is either too high or too low to ensure safe navigation. <p>If the error persists: turn the MobilePilot off and on again.</p>
<p>In Route</p> <ul style="list-style-type: none">It is important not to reduce the speed below 3 knots. MobilePilot will automatically deactivate if the speed drops below that threshold.When the user stops the vessel or ends the route, the system will return to a solid blue light state, indicating it is ready for a new route.



7. WARRANTY

LIMITED WARRANTY

This Limited Warranty grants specific legal rights to the user, which may vary by state, country, or province. The manufacturer, hereinafter referred to as SEAREBBEL, does not exclude, limit, or suspend other legal rights the user may have under applicable legislation. For a complete understanding of your rights, it is recommended to consult the regulations in your place of residence.

Coverage: This device is warranted against defects in materials or workmanship for a period of three (3) years from the date of purchase ("Warranty Period"). During this period, SEAREBBEL, at its sole discretion, will repair or replace any defective component under normal usage conditions. Repairs or replacements will be carried out at no cost to the customer for parts or labor; however, the customer will be fully responsible for shipping, handling, and insurance costs for transporting the device to and from authorized service centers.

This Limited Warranty does NOT cover:

- Cosmetic damage, such as scratches, dents, or dings.
- Consumable parts (such as batteries), unless due to manufacturing defect.
- Damage caused by accidents, abuse, misuse, submersion in water, flooding, fire, or other external causes.
- Damage resulting from service by unauthorized repair centers.
- Damage to devices modified or altered without written consent from SEAREBBEL.
- Damage caused by the use of unauthorized cables or connectors.
- Damage caused by incorrect installation or installation contrary to the user manual.
- Damage caused by use in expressly discouraged conditions, such as adverse weather or hazardous situations.

Usage Limitation and Disclaimer: The MobilePilot is a navigation assistance system, not an autonomous control system or precision navigation device. It must not be used for purposes requiring exact measurements of direction, location, or topography.

The ultimate responsibility for navigation, active monitoring, and manual control lies with the person in charge of the vessel. SEAREBBEL does not guarantee the accuracy of map data or the reliability of automated navigation activity.

SEAREBBEL will not be held liable for:

- Direct or indirect damages resulting from the use, misuse, or inability to use the device.

- Partial or total loss of insurance coverage resulting from the installation or use of the MobilePilot without prior notification to the insurance provider.
- Failure by the user to meet legal obligations, such as undergoing technical inspections or notifying the Maritime Administration of relevant modifications.

Warranty Disclaimer and Limitation of Liability:

To the maximum extent permitted by law, the warranties and remedies set forth in this document are exclusive and replace all other warranties, whether express or implied, including but not limited to warranties of merchantability or fitness for a particular purpose.

If implied warranties cannot be excluded, their duration shall be limited to the term of this limited warranty.

In no event shall SEAREBBEL, its directors, employees, or representatives be liable for any special, incidental, indirect, or consequential damages, including loss of use or data. The maximum liability shall in all cases be limited to the lesser of the amount paid for the device or €100.

Warranty Service and Claims:

Claims must be reported within a maximum of 30 calendar days from the discovery of the defect. SEAREBBEL may:

- (i) Repair the device using new or refurbished parts, (ii) Replace it with an equivalent or refurbished model, or (iii) Refund the purchase price.

The repaired or replaced device will carry a warranty of six (6) months or the remaining time of the original warranty period, whichever is longer.

Before submitting a claim, it is recommended to visit the support resources available at <https://www.searebbel.com/>. If the issue persists, technical support should be contacted.

If repair is requested outside the country of purchase, SEAREBBEL does not guarantee the availability of compatible parts. At its discretion, it may offer an equivalent model or require the device to be shipped to an authorized service center. Any use, installation, or maintenance that does not strictly comply with the user manual may void this warranty.

All costs related to compliance with import/export laws, customs duties, VAT, shipping, and other applicable taxes shall be borne by the customer.



8. LEGAL NOTICE AND DISCLAIMER

AUTHORIZED OPERATOR AND RESPONSIBILITY OF THE PERSON IN CHARGE

- The MobilePilot must be operated exclusively by the individual in command of the vessel, who must hold the maritime certification or license required under applicable law.
- SEAREBBEL shall not be held liable for any damages or losses resulting from non-compliance with this obligation.

NATURE OF THE SYSTEM

- El MobilePilot es un asistente de navegación diseñado para ayudar a la persona a cargo de la embarcación, pero no sustituye en ningún caso su deber de vigilancia activa y permanente.
- SEAREBBEL no se hace responsable de los perjuicios ocasionados si el usuario utiliza el MobilePilot como sustituto de su vigilancia, recayendo la responsabilidad última de la navegación y la seguridad de la embarcación y de sus ocupantes en la persona a cargo de la misma.

INSTALLATION AND CONFIGURATION

- The individual installing the MobilePilot undertakes to do so in strict accordance with the instructions provided in the manual. Any incident arising from installation errors shall be the sole responsibility of the installer.
- SEAREBBEL shall not be liable for incidents resulting from improper installation, misconfiguration, failure to perform required updates, or any setup that does not fully comply with the instructions outlined in the manual.

PROPER USE AND MAINTENANCE

- The user is solely responsible for any damage or harm resulting from the incorrect, improper, or negligent use of the MobilePilot, as well as from failure to follow the installation, usage, maintenance, or safety instructions provided by SEAREBBEL. The user expressly acknowledges that the system may present technical, mechanical, or software-related failures and fully assumes the risks associated with its use.
- Under no circumstances shall SEAREBBEL be held liable for direct, indirect, incidental, or consequential damages arising from the use or inability to use the MobilePilot system.

ADDITIONAL COMPLIANCE AND MARITIME REGULATIONS

- It is the sole responsibility of the user to comply with any additional inspections required by the competent Maritime Authority, as well as with any other obligations imposed by applicable maritime legislation.
- SEAREBBEL shall not be held liable for non-compliance with any applicable maritime safety regulations.

MANDATORY INSURANCE COVERAGE

- It is the user's exclusive responsibility to inform their insurance provider in advance of the installation and to verify that it is covered under their policy, in accordance with regulations governing recreational vessel insurance.
- SEAREBBEL shall in no event be liable for the total or partial loss of mandatory insurance coverage resulting from the installation or use of the MobilePilot system.



SIMPLIFIED EU DECLARATION OF CONFORMITY

SEAREBBEL S.L. hereby declares that the product MobilePilot Aur v1.0 complies with the essential requirements and other relevant provisions of Directive 2014/53/EU. The full text of the EU Declaration of Conformity is available at the following Internet address: <https://www.searebbel.com/es/declaracion-de-conformidad-ue/>

Frequency bands and maximum transmission power

This device operates on the following frequency bands and maximum transmission power levels:

Technology	Frequency Band	Maximum Transmission Power (EIRP)
Bluetooth	2400 – 2483.5 MHz	< 10 dBm (10 mW)
Wi-Fi 2.4G	2400 – 2483.5 MHz	< 20 dBm (100 mW)
NFC	13.56 MHz	< 42 dBμA/m at 10 m
GNSS (receive only)	1575.42 MHz (GPS), 1602 MHz (GLONASS)	N/A (passive)

Note: EIRP = Equivalent Isotropically Radiated Power

USAGE RESTRICTIONS BY COUNTRY

The use of this device is permitted in all European Union countries. For updated national restrictions on the use of radio equipment, please refer to the official website of the European Commission: <https://ec.europa.eu/docsroom/documents/45687>

9. GLOSSARY OF TERMS

ACCEPTANCE OF CONDITIONS: The installation and use of the MobilePilot system implies the express and unconditional acceptance of all terms outlined in this manual.

- MobilePilot or Navigation Assistance System: Electronic device designed to assist the user during navigation by providing complementary support. It does not, under any circumstances, replace the user’s duty of continuous supervision or manual control.
- User or Operator: The person responsible for commanding the vessel, who directly uses the MobilePilot and must hold the appropriate certification or license required under current legislation
- Required Certification: A certificate or license required by applicable maritime regulations that proves the user’s legal capacity to operate certain types of vessels.
- Bluetooth: Wireless technology used by the MobilePilot to communicate with compatible mobile devices, allowing configuration and remote control via a dedicated app.
- Firmware: Software embedded in the MobilePilot that controls its internal operations. This software may be periodically updated to enhance features and correct potential errors.
- Play: Abnormal space or movement between the device’s components, which may indicate incorrect installation, wear, or potential mechanical failure.
- CE Marking: Certification indicating that the MobilePilot complies with essential European regulations regarding safety and functionality.
- Active Watchkeeping: The ongoing obligation of the person in command to directly supervise the navigation, remaining ready to immediately take manual control if necessary.
- Limited Warranty: The terms under which SEAREBBEL S.L. commits to repair or replace MobilePilot components that present material or manufacturing defects within a specified period, subject to exclusions and conditions detailed in this manual.
- User Manual: Official document provided by SEAREBBEL S.L. containing all technical instructions, legal warnings, safety standards, and usage and maintenance conditions necessary for the correct installation and operation of the MobilePilot system.



10. ANNEX

INSURANCE PROVIDER NOTIFICATION TEMPLATE

Dear Sir/Madam,

I hereby inform you that, on [insert date], I will proceed with the installation of the MobilePilot system, manufactured by SEAREBBEL S.L., on my vessel [vessel name and registration number].

The MobilePilot system includes a navigation assistance device that does not replace the active, constant, and direct control and supervision of the person responsible for operating the vessel.

TECHNICAL DESCRIPTION:

The MobilePilot system consists of an integrated hardware and software package, designed as an active navigation assistant for recreational vessels. It is intended to assist with maintaining course under the continuous supervision of the person in command of the vessel, and does not replace manual control or direct watchkeeping at any time.

Hardware Components:

- Smart steering wheel: An electronic wheel specifically designed to replace the vessel's traditional steering system. It features position sensors and wireless connectivity.
- Removable battery: Provides autonomous power to the system. Delivered charged and ready for use.
- External charger: Included charging device to ensure continuous operability when not connected to the vessel's electrical system.
- Emergency disconnect button: Integrated into the device to allow immediate deactivation when needed.

SOFTWARE COMPONENTS

Mobile App (iOS and Android): Application developed by SEAREBBEL S.L. for the configuration, activation, and operation of the MobilePilot. It allows assisted course control and provides access to diagnostics, notifications, and usage history.

Component Summary:

- 1 MobilePilot smart steering wheel
- 1 removable battery
- 1 external charger
- 1 exclusive iOS & Android app for system configuration and use

I remain at your full disposal to provide any additional documentation or technical information regarding the system that may be required for coverage under my policy.

Kind regards,

[Insured's Name]
[ID/Passport Number]
[Policy Number]
[Phone Contact and Email]

Thank you for choosing Searebbel. Enjoy safer and more precise navigation!



searebbel